

Crimp contact spec

5A Crimp contact

Stamped contact

Contact diameter: $\varnothing 1$
 Material: Brass with gold plating
 Contact resistance: $5m\Omega$

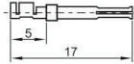
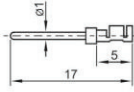

5A Male crimp contact

For SF, SA, SP, SY, WP, WS/WF/WY16-28

Wire size (mm ² / AWG)	Strip length (mm)	Part number	Crimping tool p/n	Removal tool p/n
0.20-0.52 / 24-20	5.5	YJ1-17-0.52AU	CT-P20/28	RT-1.0

5A Female crimp contact

For SF, SA, SP, SY, WP, WS/WF/WY16-28

Wire size (mm ² / AWG)	Strip length (mm)	Part number	Crimping tool p/n	Removal tool p/n
0.20-0.52 / 24-20	5.5	YK1-17-0.52AU	CT-P20/28	RT-1.0

10A Crimp contact

Machined contact

Contact diameter: $\varnothing 1.5$
 Material: Brass with gold plating
 Contact resistance: $2.5m\Omega$

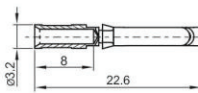
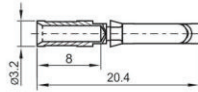
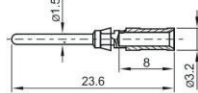
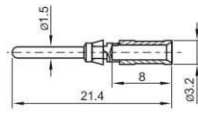

10A Male crimp contact

For SF, SA, SP, SY, WP, WS/WF/WY16-28

Wire size (mm ² / AWG)	Strip length (mm)	Part number	Crimping tool p/n	Removal tool p/n
0.14-0.37 / 26-22	8	YJ1.5-21.4-0.37AU	CT-0.14/4	RT-1.5
0.5 / 20	8	YJ1.5-21.4-0.5AU	CT-0.14/4	RT-1.5
0.75-1.0 / 18	8	YJ1.5-21.4-1.0AU	CT-0.14/4	RT-1.5
1.5 / 16	8	YJ1.5-21.4-1.5AU	CT-0.14/4	RT-1.5
2.5 / 14	8	YJ1.5-21.4-2.5AU	CT-0.14/4	RT-1.5

10A Male crimp contact

For WS/WF/WY32-55

Wire size (mm ² / AWG)	Strip length (mm)	Part number	Crimping tool p/n	Removal tool p/n
0.14-0.37 / 26-22	8	YJ1.5-23.6-0.37AU	CT-0.14/4	RT-1.5
0.5 / 20	8	YJ1.5-23.6-0.5AU	CT-0.14/4	RT-1.5
0.75-1.0 / 18	8	YJ1.5-23.6-1.0AU	CT-0.14/4	RT-1.5
1.5 / 16	8	YJ1.5-23.6-1.5AU	CT-0.14/4	RT-1.5
2.5 / 14	8	YJ1.5-23.6-2.5AU	CT-0.14/4	RT-1.5

10A Female crimp contact

For SF, SA, SP, SY, WP, WS/WF/WY16-28

Wire size (mm ² / AWG)	Strip length (mm)	Part number	Crimping tool p/n	Removal tool p/n
0.14-0.37 / 26-22	8	YK1.5-20.4-0.37AU	CT-0.14/4	RT-1.5
0.5 / 20	8	YK1.5-20.4-0.5AU	CT-0.14/4	RT-1.5
0.75-1.0 / 18	8	YK1.5-20.4-1.0AU	CT-0.14/4	RT-1.5
1.5 / 16	8	YK1.5-20.4-1.5AU	CT-0.14/4	RT-1.5
2.5 / 14	8	YK1.5-20.4-2.5AU	CT-0.14/4	RT-1.5

10A Female crimp contact

For WS/WF/WY32-55

Wire size (mm ² / AWG)	Strip length (mm)	Part number	Crimping tool p/n	Removal tool p/n
0.14-0.37 / 26-22	8	YK1.5-22.6-0.37AU	CT-0.14/4	RT-1.5
0.5 / 20	8	YK1.5-22.6-0.5AU	CT-0.14/4	RT-1.5
0.75-1.0 / 18	8	YK1.5-22.6-1.0AU	CT-0.14/4	RT-1.5
1.5 / 16	8	YK1.5-22.6-1.5AU	CT-0.14/4	RT-1.5
2.5 / 14	8	YK1.5-22.6-2.5AU	CT-0.14/4	RT-1.5

25A Crimp contact

Machined contact

Contact diameter: $\varnothing 2.5$
 Material: Brass with gold plating
 Contact resistance: $1m\Omega$

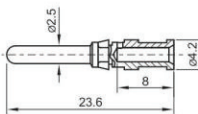
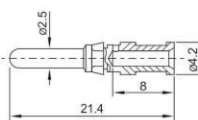

25A Male crimp contact

For SF, SA, SP, SY, WP, WS/WF/WY16-28

Wire size (mm ² / AWG)	Strip length (mm)	Part number	Crimping tool p/n	Removal tool p/n
0.75-1.0 / 18	8	YJ2.5-21.4-1.0AU	CT-0.14/4	RT-2.5
1.5 / 16	8	YJ2.5-21.4-1.5AU	CT-0.14/4	RT-2.5
2.5 / 14	8	YJ2.5-21.4-2.5AU	CT-0.14/4	RT-2.5
4.0 / 12	8	YJ2.5-21.4-4.0AU	CT-0.14/4 CT-4/10	RT-2.5

25A Male crimp contact

For WS/WF/WY32-55

Wire size (mm ² / AWG)	Strip length (mm)	Part number	Crimping tool p/n	Removal tool p/n
0.75-1.0 / 18	8	YJ2.5-23.6-1.0AU	CT-0.14/4	RT-2.5
1.5 / 16	8	YJ2.5-23.6-1.5AU	CT-0.14/4	RT-2.5
2.5 / 14	8	YJ2.5-23.6-2.5AU	CT-0.14/4	RT-2.5
4.0 / 12	8	YJ2.5-23.6-4.0AU	CT-0.14/4 CT-4/10	RT-2.5